

# PROTEC PROSICON® EPS 625

## High Temp Masking Silicone Flanged Caps

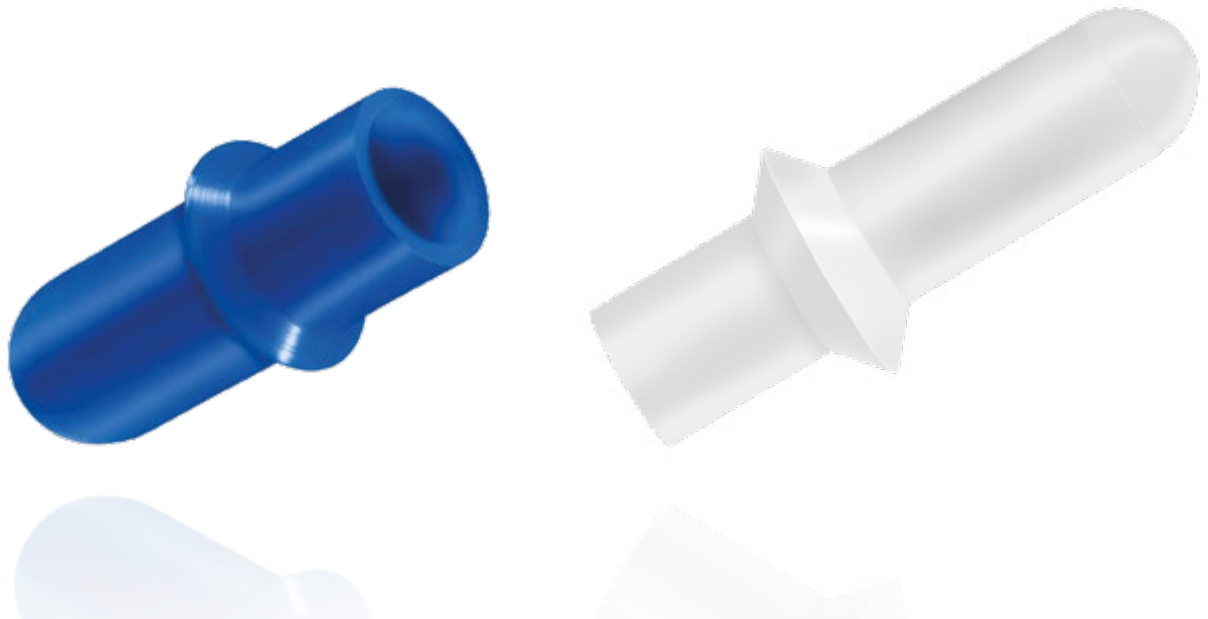

**YOUR PROSICON® PRODUCT ADVANTAGE. BEST PRICE PERFORMANCE IN THE MARKET.**

### HIGH TEMPERATURE MASKING SILICONE FLANGED CAPS:

Cylindrical shaft design. Flanged caps are designed to mask threaded holes; they will mask off the hole and the first thread of the hole.

Round profile, closed on one side. Dome top with central flange. Can be used as a plug or cap. Recommended for Powder coating, e-coating, plating & anodizing.

### PREMIUM SILICONE MATERIAL PROPERTIES.

Prosicon® Silicone rubber 55 shore A withstands temperatures up to max. 316 ° C / 4 hours. On request also in EPDM material up to max. 177 ° C available.

### PROSICON® BLU SIGNATURE® PRODUCT CODE.

Premium. Reusable. Stabilized with Special Blends.

### COLOR OPTIONS.

Special color runs available on request.

### TECHNICAL CLEANLINESS FOR ACCURATE MASKING.

Prosicon® Silicone Maskign Caps and Plugs are stabilized and tempered separately. This process improves dimensional stability and prevents plasticizer exudation during customer applications under high temperature conditions.

### PREMIUM SILICONE MATERIAL PROPERTIES.

Prosicon® Silicone Maskign Caps and Plugs have an excellent resistance to high temperature, chemicals and acids and can be used several times without loss of quality.

**HEAT RESISTANT!**

### MATERIALS SELECTION GUIDE.

EPDM rubber, Neoprene, NBR rubber, SBR, TPE, ecc.

### APPLICATION.

High Temperature Masking Caps and Plugs to protect your product during finishing processes like powder coating, KTL, Wet painting, anodizing, electroplating and e.coating treatments. Extremely temperature resistant up to 316° C, robust, versatile and time-saving in application.

### SILICONE / EPDM CUSTOM DESIGN AT RECORD SPEED.

On request we develop and produce individually tailored solutions along with the standard items of this range: If you require additional dimensions, different materials and new colours. We would be pleased to assist you.

- |                    |   |
|--------------------|---|
| <b>Customized.</b> | For your special application                    |
| <b>Time Saver.</b> | Rapid Prototyping & Hi-Speed functional samples |
| <b>Hi-Speed.</b>   | Fast Lane Serial Mold Construction              |
| <b>Unbeatable.</b> | At the best price in the market                 |

# PROTEC PROSICON® EPS 625

## High Temp Masking Silicone Flanged Caps

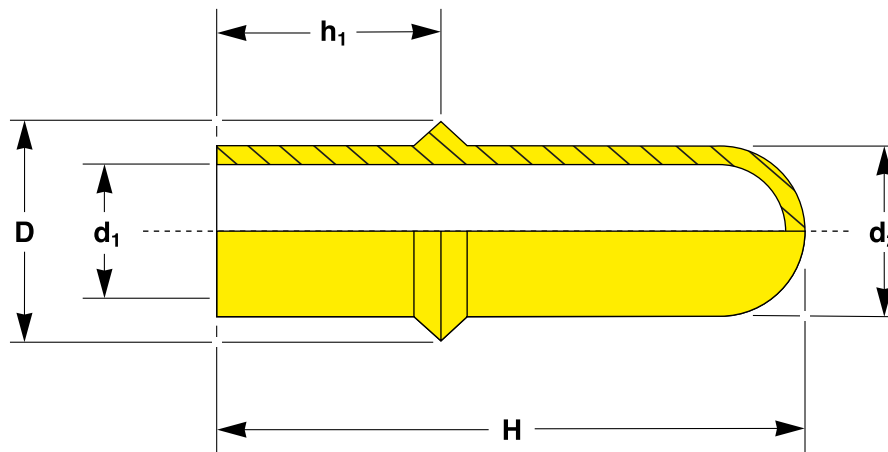

### DIMENSIONS

All dimensions in mm

Dimensions					Standard Pack	Color	Reference No.
$d_1$	$d_2$	D	H	$h_1$			
4.39	7.39	11.99	30.99	11.99	250	yellow	EPS 625 / M 8
5.69	8.71	14.71	32.00	13.00	250	pink	EPS 625 / M10
7.65	10.69	15.80	33.02	14.00	250	natural	EPS 625 / M12
8.00	10.69	15.80	45.66	14.00	250	natural	EPS 625 / M12L
10.69	13.69	18.01	34.04	15.01	250	grey	EPS 625 / M14
9.55	12.70	17.53	57.15	17.02	250	natural	EPS 625 / M14L

Should your requirements not be shown please ask for a separate quotation.  
SEALWELL products and specifications are subject to improvement and change without notice.