

# PROTEC PROSICON® EPS 350

## High Temp Masking Dual Flanged Pull Plugs

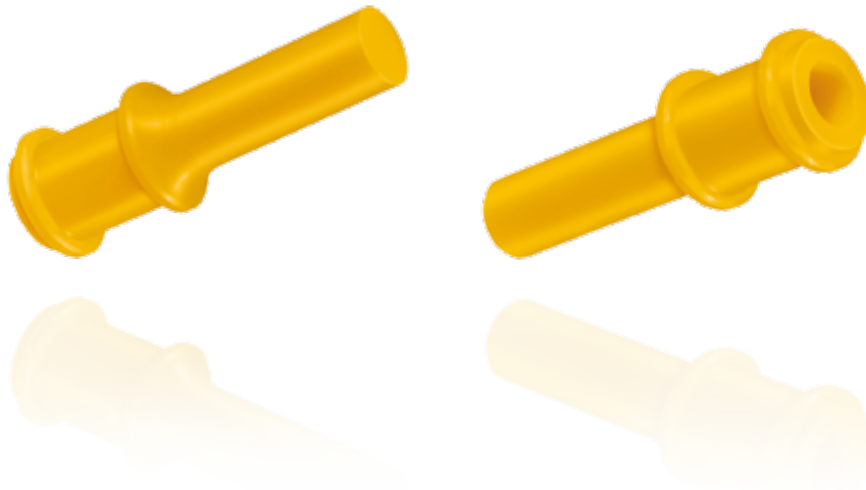

**YOUR PROSICON® PRODUCT ADVANTAGE. BEST PRICE PERFORMANCE IN THE MARKET.**

**HEAT RESISTANT!**

### HIGH TEMP MASKING DUAL FLANGED PULL PLUGS.

Designed for weld nuts of varying thread sizes.  
Will not blow out due to air pressure.

Recommended for Powder coating, e-coating, plating & anodizing.

### PREMIUM SILICONE MATERIAL PROPERTIES.

Prosicon® Silicone rubber 55 shore A withstands temperatures up to max. 316 ° C / 4 hours. On request also in EPDM material up to max. 177 ° C available.

### PROSICON® BLU SIGNATURE® PRODUCT CODE.

Premium. Reusable. Stabilized with Special Blends.

### COLOR OPTIONS.

Special color runs available on request.

### TECHNICAL CLEANLINESS FOR ACCURATE MASKING.

Prosicon® Silicone Maskign Caps and Plugs are stabilized and tempered separately. This process improves dimensional stability and prevents plasticizer exudation during customer applications under high temperature conditions.

### PREMIUM SILICONE MATERIAL PROPERTIES.

Prosicon® Silicone Maskign Caps and Plugs have an excellent resistance to high temperature, chemicals and acids and can be used several times without loss of quality.

### MATERIALS SELECTION GUIDE.

EPDM rubber, Neoprene, NBR rubber, SBR, TPE, ecc.

### APPLICATION.

High Temperature Masking Caps and Plugs to protect your product during finishing processes like powder coating, KTL, Wet painting, anodizing, electroplating and e.coating treatments. Extremely temperature resistant up to 316° C, robust, versatile and time-saving in application.

### SILICONE / EPDM CUSTOM DESIGN AT RECORD SPEED.

On request we develop and produce individually tailored solutions along with the standard items of this range: If you require additional dimensions, different materials and new colours. We would be pleased to assist you.

- Customized.** For your special application
- Time Saver.** Rapid Prototyping & Hi-Speed functional samples
- Hi-Speed.** Fast Lane Serial Mold Construction
- Unbeatable.** At the best price in the market

# PROTEC PROSICON® EPS 350

## High Temp Masking Dual Flanged Pull Plugs

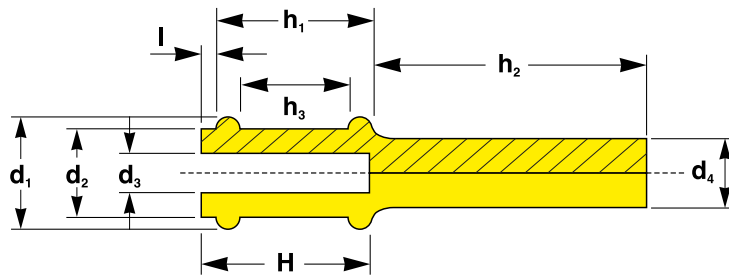

### DIMENSIONS

All dimensions in mm

Dimensions									Shore A	Color	Std. Pack	Reference No.
$d_1$	$d_2$	$d_3$	$d_4$	$h_1$	$h_2$	$h_3$	$H$	$I$				
6.93	4.06	1.02	2.03	9.37	15.34	6.22	26.75	1.57	40-45	black	500	EPS 350 / M5
7.80	5.00	1.85	5.00	10.26	20.42	6.73	9.14	2.03	40-45	green	500	EPS 350 / M6
9.50	6.71	3.28	5.59	12.32	19.76	8.76	10.41	2.03	40-45	blue	500	EPS 350 / M8XL
9.50	6.71	3.28	3.81	11.56	20.52	8.00	10.41	2.03	40-45	red	500	EPS 350 / M8
9.53	6.63	3.56	5.33	10.67	20.57	7.11	12.95	1.78	40-45	blue	500	EPS 350 / 0261
10.67	6.86	3.81	5.72	9.88	19.05	6.73	15.88	3.18	40-45	white	500	EPS 350 / 0270A
10.80	8.00	4.57	5.08	10.67	20.42	6.60	9.14	2.03	40-45	black	500	EPS 350 / 0315
11.30	8.51	5.08	3.81	10.16	20.42	6.60	9.14	2.03	40-45	green	500	EPS 350 / 0335
11.30	8.51	5.08	3.81	12.55	20.42	8.99	11.43	2.03	40-45	green	500	EPS 350 / M10
11.30	8.51	5.08	6.99	12.55	20.42	8.99	11.43	2.03	40-45	pink	500	EPS 350 / 0335L
13.00	10.26	5.08	5.61	13.97	25.40	9.91	9.14	2.03	40-45	yellow	250	EPS 350 / 0404
13.00	10.31	5.08	5.61	10.16	27.81	6.60	9.14	2.03	40-45	violet	250	EPS 350 / 0410
13.00	10.31	5.08	5.61	15.16	26.80	11.61	14.15	2.03	40-45	violet	250	EPS 350 / M12
13.21	10.16	5.08	7.62	15.37	27.05	11.30	17.91	2.03	40-45	yellow	250	EPS 350 / 0400
16.99	13.46	7.87	10.16	18.03	32.00	13.97	20.57	2.03	40-45	green	100	EPS 350 / 0530
17.40	13.59	7.11	8.89	17.53	31.24	13.97	16.51	2.03	40-45	white	100	EPS 350 / M16
21.01	16.99	10.52	12.29	21.59	34.38	18.01	20.55	2.03	40-45	blue	100	EPS 350 / M20

Should your requirements not be shown please ask for a separate quotation.  
SEALWELL products and specifications are subject to improvement and change without notice.